

1

2

3

4

5

6

A

B

C

D

A

B

C

D

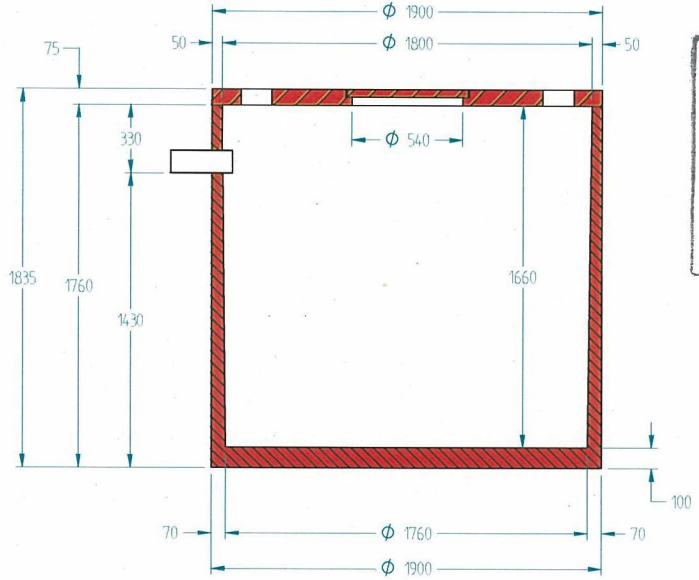
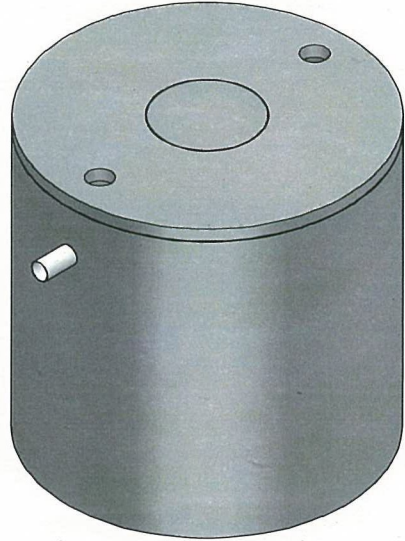
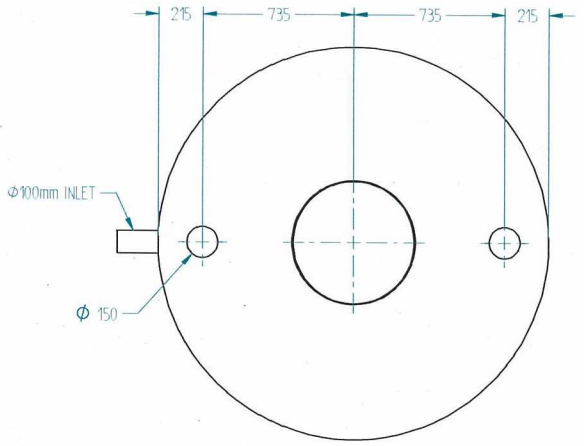

APPROVED  
18 AUG 2010  
DEPARTMENT OF HEALTH, N.S.W.

**NOTES:**

1. SEPTIC TANKS TO BE MANUFACTURED AND TESTED IN ACCORDANCE WITH AS/NZS 1546.1:2008
2. CONCRETE STRENGTH = 40MPa
3. CONCRETE TO BE VIBRATED TO ENSURE WELL COMPACTED CONCRETE
4. TANKS TO BE REINFORCED WITH FIBRE STEEL
5. LIFTING TO BE "REID SWIFT LIFTS" 4 x 2.5 TONNE FOOT ANCHORS CAST INTO BASE OF THE TANK, 3 x 1.3 TONNE ANCHORS CAST INTO TANK LIDS

<p>ERATED WASTE-WATER TREATMENT SYSTEMS</p>		PROJECT COLLECITON WELL	
		TITLE 3250L CONCRETE TANK ASSY NSW HEALTH CERTIFICATION DRAWING	
<p><b>COPYRIGHT</b></p> <p><small>THIS DRAWING AND ANY PARTS OF IT ARE THE PROPERTY OF ECONOCYCLE AND SHALL REMAIN THE PROPERTY OF ECONOCYCLE WHETHER WRITTEN OR NOT.</small></p>	SCALE DO NOT SCALE	DATE PLOTTED 27/07/2010	COAT/TREAT -
	<p>DRAWN BY P. MCKAY</p> <p>MODELLED BY P. MCKAY</p>	<p>DRAWING LAST MODIFIED BY P. MCKAY</p> <p>MODEL LAST MODIFIED BY P. MCKAY</p>	PART#
124_1410			SHEET No. 1 OF 1

1

2

3

4

5

6